

DR Small Sirocco Fan

Guide

DR-F10/E10CSA	DR-F15CSB/CTA	DR-F19DSB/DTA
DR-G25DSB/DTA	DR-F28FSA/FTA	DR-G28FSA/FTA
DR-G29FSA/FTA(Ø300)	DR-F29FSA/FTA	DR-F29FSA/FTA(Ø250)
DR-F30FSA		

DR-FS19DSA/DTA	DR-GS25DSA/DTA	DR-FS28FSA/FTA
DR-GS28FSA/FTA	DR-FS29FSB/FTB	

Index

- | | | |
|----------------------|---|---|
| 1. Warning | 4. Specification performance / breaker capacity | 7. Exploded assembly drawing / parts identification diagram |
| 2. Cautions | 5. Installation method | 8. Product warranty |
| 3. Drawing/Dimension | 6. Electrical work | |

- Thank you for purchasing the DR small sirocco fan.
- For correct use of product, make sure to read this manual.
- This user manual is intended to be used conveniently and stored well when problems occur while using the product.

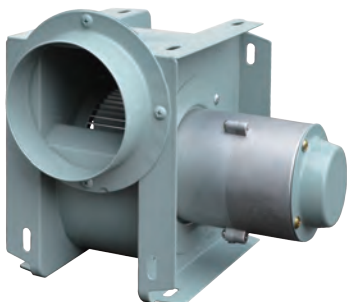

대륜산업주식회사
Dae Ryun Ind. Co., Ltd.

DR Fan & Blower
Electric Motor

1. Warning

※ Overview

Information for safe use of product

This manual was prepared to ensure safe and efficient use of product. Before using product, make sure to sufficiently understand the content of this manual in order to install and use product accurately, and therefore prevent accidents beforehand.



Warning

The instructions below must be followed to prevent the damage of serious injury or death, etc.

- 1) Make sure to complete ground connection.
 - This is required to prevent fire or electric shock.
- 2) Make sure to install an earth leakage breaker.
 - This is required to prevent fire or electric shock.
- 3) Do not install product in a place where the level of humidity is high.
 - This is required to prevent fire or electric shock.
- 4) Install power switch and connection socket in a dry place.
 - This is required to prevent fire or electric shock.
- 5) Connect power after fully completing product installation.
 - This is required to prevent fire or electric shock.
- 6) Do not install product in a place where there is a risk of explosion or flammable gas, etc.
 - Explosion or fire can be caused by a short circuit or spark, etc.
- 7) For installation on a wall or ceiling, make sure to securely fix product in position.
 - Falling of product can cause serious injury or death, and property damage.
- 8) Do not change or remodel product without permission.
 - This is required to prevent fire or electric shock.
- 9) Do not insert your finger or a stick, etc. to the rotating wings under any circumstances while power is connected.
 - This is required to prevent amputation of the finger.
- 10) Do not touch product with wet hands.
 - This is required to prevent fire or electric shock.
- 11) Make sure to proceed with repair or cleaning of product after removing power plug from power outlet. (Turn off breaker.)
 - This is required to prevent fire or electric shock.
- 12) If power plug or cord is damaged, do not use it and buy a new one from a distributor.
 - This is required to prevent fire or electric shock.
- 13) If power cord has been damaged, make sure to have the power cord replaced by the manufacturer, distributor, or a qualified technician in order to prevent any risk.
- 14) After disconnecting power, gently wipe product using a dry cloth without moisture or oil. (Keep product and motor away from moisture.)
 - Moisture or water on electrical parts can cause a short circuit or electric shock.
- 15) When connecting multiple plugs to a single power outlet, make sure to use an outlet with an appropriate capacity by consulting an expert.
 - This is required to prevent the risk of fire.

2. Cautions



Caution

A person who still requires supervision or lacks training, a person who has a physical disability, a person of old age, a person who has a psychological problem, or a person who lacks experience and knowledge must not use this device. Supervision is required to prevent children from using this device as a toy.

- 1) Keep the exhaust pipe short, and the degree of curvature small.
 - Otherwise, noise is increased, and displacement is decreased.
- 2) After installing product, check strength of the installation.
 - If the strength of installation is low, it can cause falling of product as well as noise and vibration.
- 3) Do not install product near a gas cooker or a heater, or in a place where temperature around the fan is 60°C or higher.
 - This is required to not only prevent the risk of fire, but also significant deterioration of product durability.
- 4) For product installation in a closed space, install an inlet port with diameter the same as or larger than that of the fan.
 - Without an inlet port, exhaust function of the fan is deteriorated.
- 5) Do not install product in a location where there is a risk of freezing.
 - This can cause product to be inoperable.
- 6) The wings must rotate in a direction from the outlet port to the user.
 - Rotation of wings in the reverse direction has the risk of causing fire.
- 7) Make sure to check the rated voltage of product, and do not use product of which the rated voltage is not available.
 - There is the risk of fire and deterioration of product performance.
- 8) Do not use product for a long time in a place where intake temperature of product during operation is 40°C or higher.
 - Insulation of electrical parts can be lowered, causing significant deterioration of product durability.
- 9) Turn off power if not using product for a long time.
- 10) While the wings are rotating, keep curtains, strings or any other objects from getting rolled into the fan.
 - Motor can be damaged, causing fire.
- 11) Protect the wings from damage or deformation.
 - This can cause noise, vibration, and deterioration of product durability.
- 12) Do not clean product using thinner, benzol, kerosene, or polishing powder, etc.
 - There is the risk of fire, discoloration, or deformation.
- 13) Do not use product in a place where chemicals or other hazardous substances that can inflict harm to the main body of product are handled.
 - This can cause significant deterioration of product durability.
- 14) Before removing guard, check if the main power switch of the fan is turned off.
- 15) Product must be installed in a way that the fan is located at least 2.3m from the floor surface.
- 16) Before installing product, take measures in advance to prevent inflow of gas to the interior space through the fan or from any devices for fuel use.

3. Drawing/Dimension

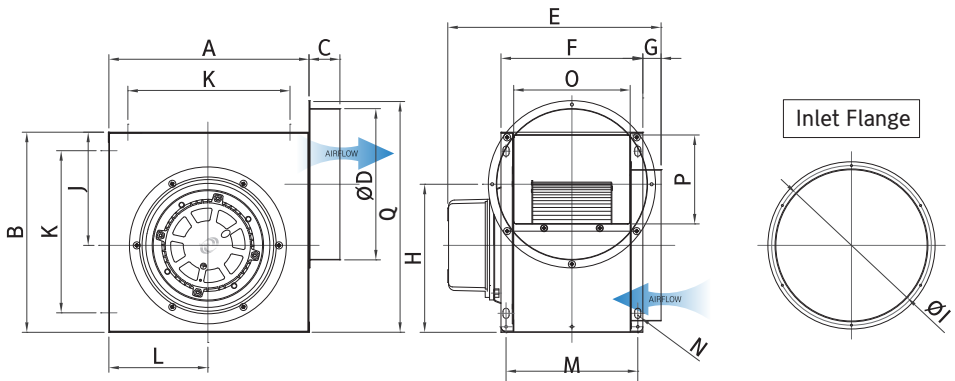

Unit : mm

MODEL No.	A	B	C	ØD	E	F	G	H	ØI	J	K	L	M	N	O	P	DUCT	
DR-F10CSA	180	180	31	98	230	140	2	141	98	101	120	92.5	104	7 × 18	80	74	Ø100	
DR-E10CSA																		
DR-F15CSB																		
DR-F15CTA																		
DR-F19DSB	300	300	50	199	315	185	30	215	199	150	240	150	165	10 × 16	140	135	Ø200	
DR-F19DTA																		
DR-G25DSB																		
DR-G25DTA																		
DR-F28FSA	395	395	50	249	375	250	25	302	249	195	320	195	230	12 × 20	200	175	Ø250	
DR-F28FTA																		
DR-G28FSA																		
DR-G28FTA																		
DR-G29FSA(Ø300)	395	395	60	299	415	280	35	292	299	195	320	195	260	12 × 20	230	175	Ø300	
DR-G29FTA(Ø300)																		
DR-F29FSA																		
DR-F29FTA																		
DR-F29FSA(Ø250)			50	249					249									Ø250
DR-F29FTA(Ø250)																		
DR-F30FSA	395	395	60	299	415	290	35	292	299	195	320	195	270	12 × 20	240	175	Ø300	
MODEL No.	A	B	C	ØD	E	F	G	H	ØI	J	K	L	M	N	O	P	DUCT	
DR-FS19DSA	300	300	50	199	315	185	30	215	199	150	240	150	165	10 × 16	140	135	Ø200	
DR-FS19DTA																		
DR-GS25DSA	395	395	50	249	375	250	25	302	249	195	320	195	230	12 × 20	200	175	Ø250	
DR-GS25DTA																		
DR-FS28FSA																		
DR-FS28FTA																		
DR-GS28FSA																		
DR-GS28FTA																		
DR-FS29FSB																		
DR-FS29FTB																		

4. Specification Performance / Breaker Capacity

MODEL No.	Impeller Size (mm)	Maximum air volume (m ³ /h)		maximum static pressure (mmAq)		Phase (φ)	Volt (V)	Poles (P)	Input (W)	Ampere (A)		Weight (Kg)
		50Hz	60Hz	50Hz	60Hz					50Hz	60Hz	
DR-F10CSA	Ø100x57	-	250	-	9.3	1	220	4	40	-	0.19	3.2
DR-E10CSA	Ø105x60	-	300	-	37	1	220	2	80	-	0.45	
DR-F15CSB	Ø160x90	660	1,000	15	23	1	220	4	103	0.4	0.6	6.5
DR-F15CTA						3	220/380			0.1	0.32/0.18	
DR-F19DSB	Ø180x110	1,320	1,500	18	34	1	220	4	260	1.5	2.16	11
DR-F19DTA						3	220/380			0.5	1.39/0.78	
DR-G25DSB	Ø250x130	1,620	2,200	16	25	1	220	6	380	1	1.6	21
DR-G25DTA						3	220/380			0.6	1.57/0.88	
DR-F28FSA	Ø250x130	2,940	3,500	35	51	1	220	4	1,200	3.8	6	23
DR-F28FTA						3	220/380			2.12	4.27/2.4	
DR-F28FSA(ø300)	Ø250x130	2,940	3,500	35	51	1	220	4	1,200	3.8	6	23
DR-F28FTA(ø300)						3	220/380			2.12	4.27/2.4	
DR-G28FSA	Ø250x155	2,070	3,180	17	30	1	220	6	525	1.15	2.8	23
DR-G28FTA						3	220/380			1.63	2.03/1.14	
DR-G29FSA(ø300)	Ø250x155	-	3,180	-	30	1	220	6	525	-	2.8	23
DR-G29FTA(ø300)						3	220/380			-	2.03/1.14	
DR-F29FSA	Ø250x155	3,390	4,500	39	57	1	220	4	1,500	5.2	7.6	25
DR-F29FTA						3	220/380			1.8	5.66/2.7	
DR-F29FSA(ø250)	Ø250x155	3,390	4,500	39	57	1	220	4	1,500	5.2	7.3	25
DR-F29FTA(ø250)						3	220/380			1.8	5.22/2.93	
DR-F30FSA	Ø260x160	-	5,500	-	71	1	220	4	1,650	-	8.82	24
MODEL No.	Impeller Size (mm)	Maximum air volume (m ³ /h)		maximum static pressure (mmAq)		Phase (φ)	Volt (V)	Poles (P)	Input (W)	Ampere (A)		Weight (Kg)
		50Hz	60Hz	50Hz	60Hz					50Hz	60Hz	
DR-FS19DSA	Ø180x110	1,320	1,500	18	34	1	220	4	260	1.5	2.16	11
DR-FS19DTA						3	220/380			0.5	1.39/0.78	
DR-GS25DSA	Ø250x130	1,620	2,200	16	25	1	220	6	380	1	1.6	21
DR-GS25DTA						3	220/380			0.6	1.57/0.88	
DR-FS28FSA	Ø250x130	2,940	3,500	35	51	1	220	4	1,200	3.8	6	23
DR-FS28FTA						3	220/380			2.12	4.27/2.4	
DR-GS28FSA	Ø250x155	2,070	3,180	17	30	1	220	6	525	1.15	2.8	23
DR-GS28FTA						3	220/380			1.63	2.03/1.14	
DR-FS29FSB	Ø250x155	3,390	4,500	39	57	1	220	4	1,500	5.2	7.3	25
DR-FS29FTB						3	220/380			1.8	5.22/2.93	

5. Installation

※ The user must purchase necessary accessories (mounting stand, duct) for installation.

※ In case of floor installation

※ For horizontal installation

※ In the case of ceiling installation

If the floor is not flat, use a mounting stand (purchased by the user).

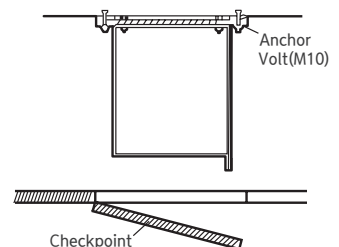
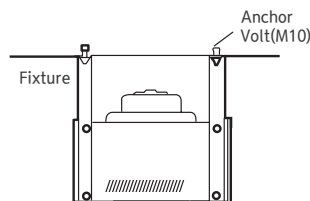
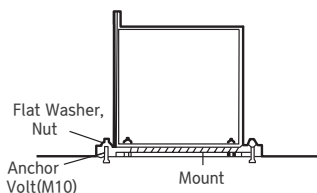

6. Duct /Electrical construction

■ Duct construction

- Connect the flanges fastened on the suction and discharge sides to the outer duct.
After connection, fix the rivet and tape it on top to prevent loss of wind.
Fasten the flange to the body once again.
- Since the discharge side flange has a direction, character stickers are attached to the flange and body.
Tighten according to the mark.

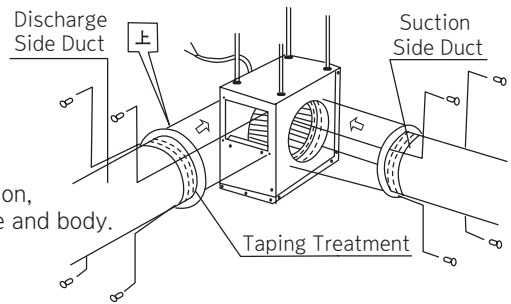

■ Caution

- After fastening the flange to the main body, seal it with caulking material to prevent wind loss.

■ Electrical construction

Single Phase 220V

● Wiring Diagram

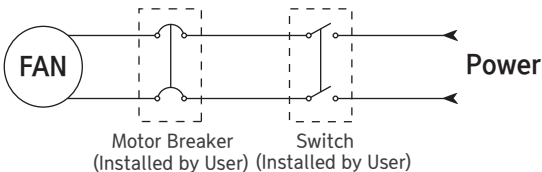

● Connection Diagram

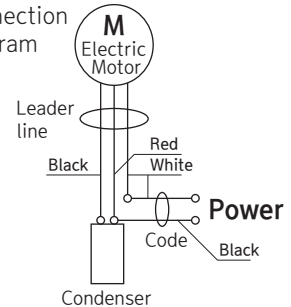

Three Phases 220V, 380V

● Wiring Diagram

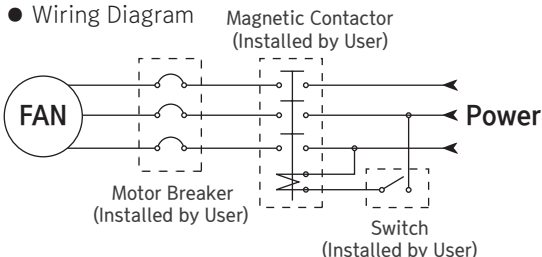

● Connection Diagram

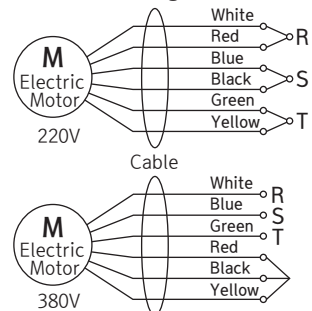

※ After checking whether the input voltage is 220V or 380V, connect according to the wiring diagram.
There is a risk of motor burnout during wiring.

7. Exploded Diagram

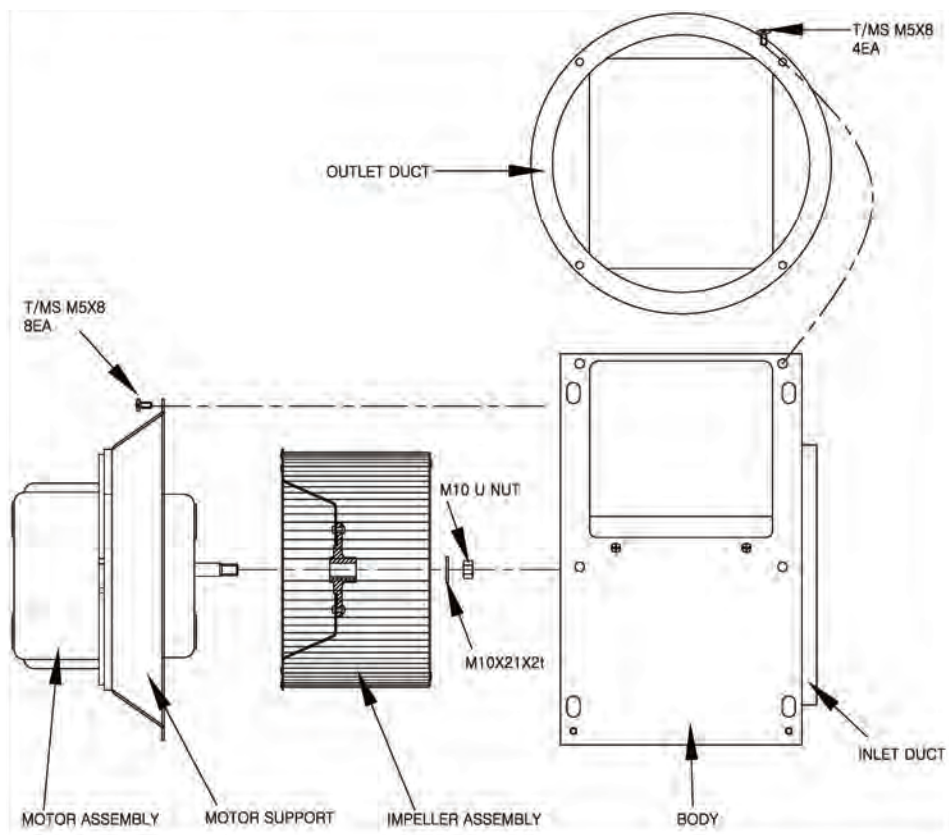

PRODUCT WARRANTY

Small Sirocco Fan Product warranty period 1 Year.

Product Name	DR Small Sirocco Fan		
MODEL NO.	<input type="checkbox"/> DR-F10/E10CSA <input type="checkbox"/> DR-G25DSB/DTA <input type="checkbox"/> DR-G29FSA/FTA(Ø300) <input type="checkbox"/> DR-FS19DSA/DTA <input type="checkbox"/> DR-GS28FSA/FTA	<input type="checkbox"/> DR-F15CSB/CTA <input type="checkbox"/> DR-F28FSA/FTA <input type="checkbox"/> DR-F29FSA/FTA <input type="checkbox"/> DR-GS25DSA/DTA <input type="checkbox"/> DR-FS29FSB/FTB	<input type="checkbox"/> DR-F19DSB/DTA <input type="checkbox"/> DR-G28FSA/FTA <input type="checkbox"/> DR-F29FSA/FTA(Ø250) <input type="checkbox"/> DR-FS28FSA/FTA <input type="checkbox"/> DR-30FSA
Serial NO.			
Date of Purchase	. . .		
Agency			

- Please confirm that there are no items not listed in the prescribed items of this warranty.
- We guarantee according to the contents of this warranty.
- See below for warranty details (conditions).
- If a malfunction occurs during use, ask for service at the service center.
- Please keep this warranty as it will not be reissued.

Warranty details (condition)

1. In the case of a manufacturing defect or natural failure within the warranty period, we provide free service.
2. In the following cases, you will receive paid service even during the warranty period.
 - Failure due to misuse or careless handling
 - Failure due to repair or modification not through our service center.
 - Failures due to natural disasters (fire, salt damage, gas damage, earthquake, wind and flood damage, lightning, abnormal voltage, abnormal frequency, etc.)
 - If there is no quality guarantee or if there is no content in the warranty.
3. We provide paid service for malfunctions that occur after the warranty period has elapsed from the date of purchase.

Manufacturing and Sales

- Headquarters / Factory 115, Wanjusandan 7-ro, Bongdong-eup, Wanju_Gun, Jeollabuk-do, Republic of Korea
T. +82-63-262-5100 / F. +82-63-262-5107
- Central office 608, Mado-ro, Mado-myeon, Hwaseong-si, Gyeonggi-do, Republic of Korea
T. +82-31- 8047-5161/F. +82-31-8047-5163



www.drair.co.kr

※ These specifications are subject to change without notice for product improvement.